

更改 REV	变更内容 MODIFICATION	日期 DATE	制图 DRAW	审核 APPROVE
A	版面发行	2012/10/29	JDL	Oscar

NOTES:

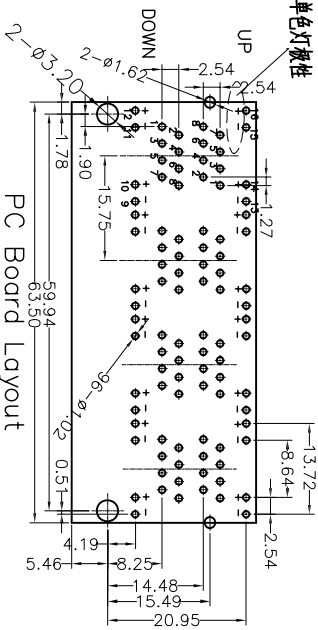
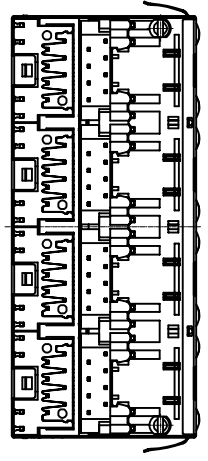
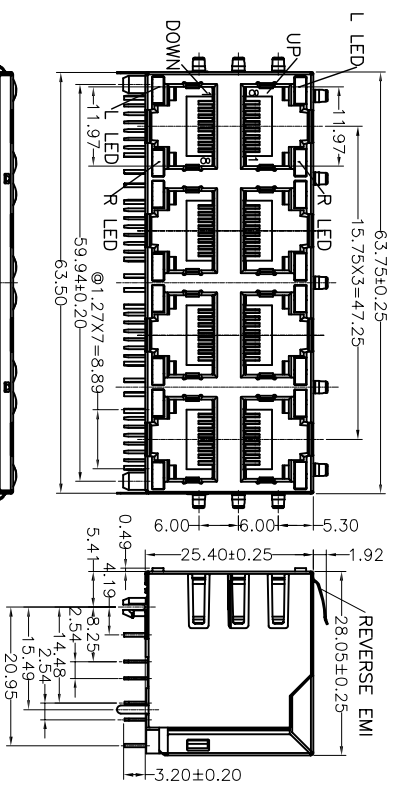
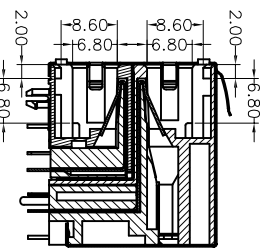

- L LED
- 16 YELLOW
 - 15 YELLOW
 - 12 YELLOW
 - 11 YELLOW
- R LED
- 14 GREEN
 - 13 GREEN
 - 10 GREEN
 - 9 GREEN

PART NUMBER: 59A-S2488L1-E2XX

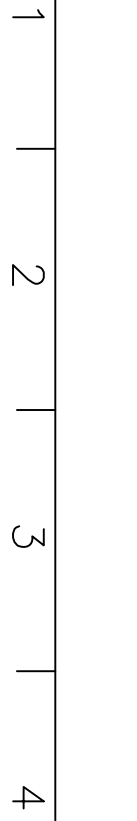
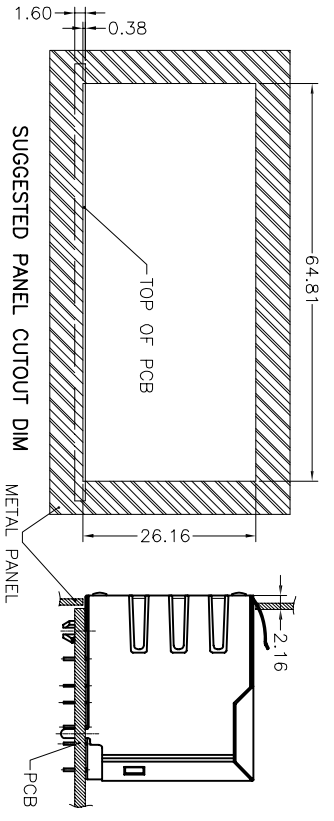
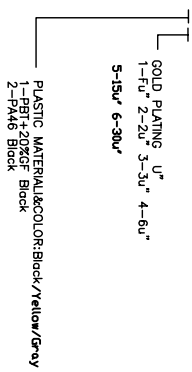

HTTP://WWW.RJ45JACK.COM YOU LONG CONNECT THE WORLD		YOU LONG ELECTRONICS LIMITED	
DIMENSION IN mm [Inch]		规格 TITLE	
TOLERANCE UNLESS OTHERWISE SPECIFIED		文件号 FILE NO.	
.X±0.20 X*±1*		图号 DWG NO. YL59A-S2488L1-E2	
.XX±0.15 X*±0.5*		59A 2X4 BRPC PCB JACK&SHIELDED WITH EMI FINGER SIDE ENTRY/FLAT PIN	
.XXX±0.075		审核 CHECK	
: Inspection Item		制图 DRAW	
: Cp/Cpk and SPC Control Item		Oscar	
APPROVE		审核 SCALE	
APPROVE		比例 SCALE 1:1	
APPROVE		图幅 SIZE A3	
APPROVE		数量 REV 1	
APPROVE		版本 REV A	