

更改 REV	变更内容 MODIFICATION	日期 DATE	制图 DRAW	审核 APPROVE
A	版面发行	2012/10/29	JDL	Oscar

NOTES:

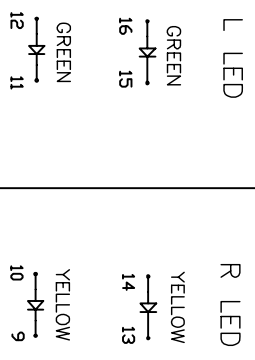
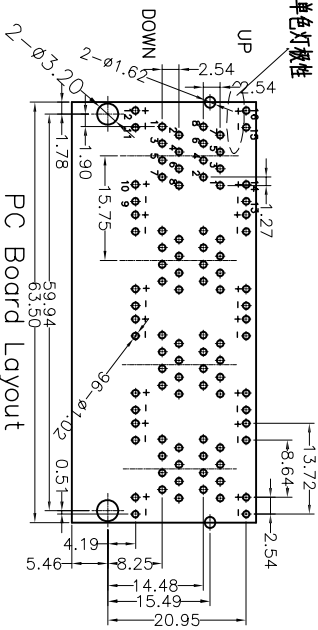
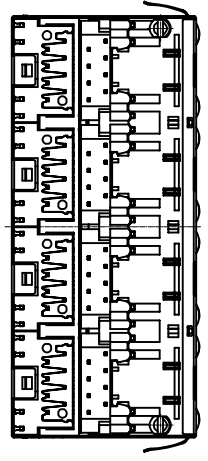
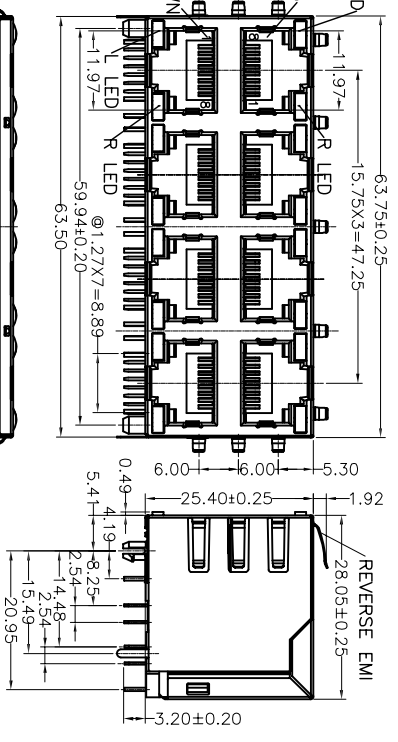
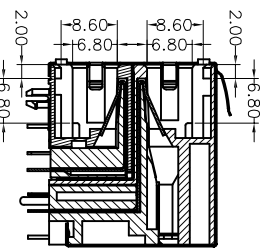

PART NUMBER: 59A-S2488L2-E2XX

- MATERIAL:
- 1.HOUSING MATERIAL :GLASS FILLED POLYESTER(U194W-0)
  - 2.CONTACT MATERIAL :PHOSPHOR BRONZE Ø0.46mm (C51100).
  - 3.PLATING :GOLD PLATING OVER NICKEL.
  - 4.SHIELD COPPER ALLOY(OR STEEL ALLOY) 0.20mm THICKNESS PLATING NI.
  - 5.LED:OPTION.
- ELECTRICAL:
- 1.VOLTAGE RATING :125 VAC RMS.
  - 2.CURRENT RATING :1.5 AMP.
  - 3.CONTACT RESISTANCE :50 MILLIOHMS MAX.
  - 4.INSULATION RESISTANCE :500 MEGOHMS MIN @ 500V DC.
  - 5.DIELECTRIC WITHSTANDING RESISTANCE :1000V AC RMS 50HZ. 1MIN.
  - 6.LED RATINGS:FORWARD VOLTAGE:2.2 VOLTS TYPICAL. REVERSE VOLTAGE:5 VOLTS MAXIMUM.
- MECHANICAL:
- 1.DURABILITY:750 CYCLES MIN.
  - 2.PCB RETENTION PRE-SOLDER
- ENVIRONMENTAL:
- 1.STORAGE :-40°C TO +85°C.
  - 2.OPERATION :-20°C TO 70°C.
- MATES WITH MODULAR PLUG CONFORMING TO FCC PART 68,SUBPART F.

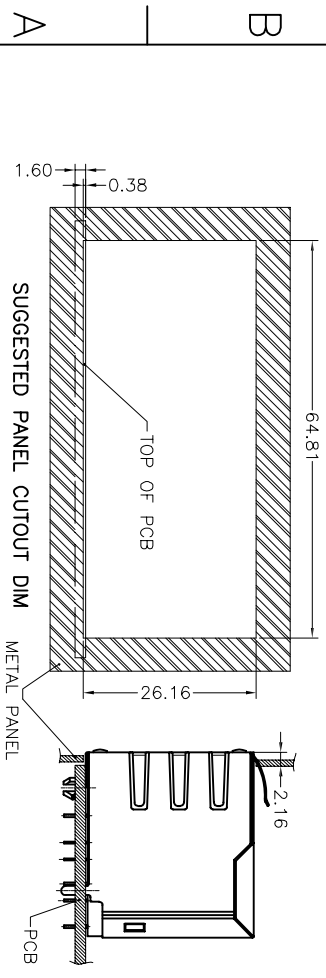
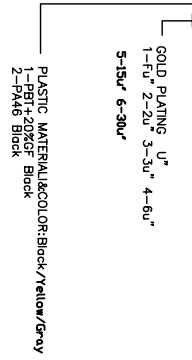

If you have any questions,Don't hesitate to email sales@j45jack.com,please!

<p>QC : Inspection Item</p> <p>CPK : Cp/Cpk and SPC Control Item</p>		<p>HTTP://WWW.RJ45JACK.COM</p>	
<p>DIMENSION IN mm [Inch]</p> <p>TOLERANCE UNLESS OTHERWISE SPECIFIED</p> <p>.X±0.20 X*±1*</p> <p>.XXX±0.15 .X*±0.5*</p> <p>.XXXX±0.075</p>		<p>YOU LONG CONNECT THE WORLD</p> <p>YOU LONG ELECTRONICS LIMITED</p>	
<p>公差 APPROVE</p> <p>公差 CHECK</p>		<p>图号 FILE NO.</p> <p>59A 2X4 8PBC PCB JACK&amp;SHIELDED WITH EMI FINGER SIDE ENTRY/FLAT PIN</p> <p>图号 Dwg NO. YL59A-S2488L2-E2</p>	
<p>比例 DRAW</p> <p>Oscdr</p>		<p>审核 PROU.</p> <p>比例 SCALE</p> <p>1:1</p> <p>图幅 SIZE</p> <p>A3</p> <p>页数 REV</p> <p>1 / 1</p> <p>审核 APPROVE</p> <p>A</p>	