

| | | | | |
|-----------|----------------------|------------|------------|---------------|
| 更改 REV | 变更内容 MODIFICATION | 日期 DATE | 绘图 DRAW | 批准 APPROVE |
| A | 版面发行 | 2012/10/29 | JDL | Oscar |

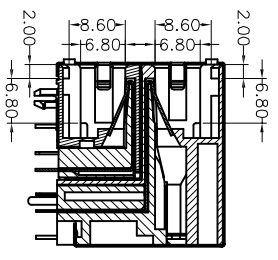
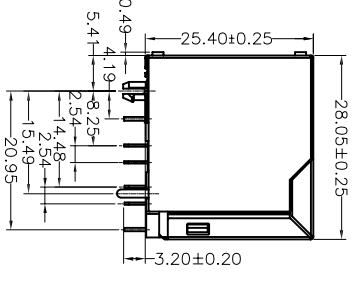
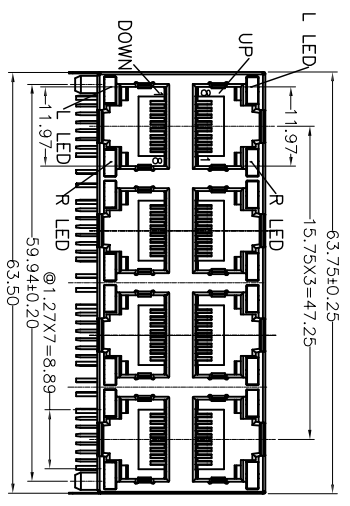

NOTES:

MATERIAL:
 1.HOUSING MATERIAL :GLASS FILLED POLYESTER(U194V-0)
 2.CONTACT MATERIAL :PHOSPHOR BRONZE Ø0.46mm (C5100).
 3.PLATING :GOLD PLATING OVER NICKEL.
 4.SHIELD COPPER ALLOY(OR STEEL ALLOY) 0.20mm THICKNESS PLATING NI.
 5.LED:OPTION.

ELECTRICAL:
 1.VOLTAGE RATING :125 VAC RMS.
 2.CURRENT RATING :1.5 AMP.
 3.CONTACT RESISTANCE :50 MILLIOHMS MAX.
 4.INSULATION RESISTANCE :500 MEGOHMS MIN @ 500V DC.
 5.DIELECTRIC WITHSTANDING RESISTANCE :1000V AC RMS 50Hz. 1MIN.
 6.LED RATINGS:FORWARD VOLTAGE:2.2 VOLTS TYPICAL. REVERSE VOLTAGE:5 VOLTS MAXIMUM.

MECHANICAL:
 1.DURABILITY:750 CYCLES MIN.
 2.PCB RETENTION PRE-SOLDER ENVIRONMENTAL:
 1.STORAGE :-40°C TO +85°C.
 2.OPERATION :-20°C TO 70°C.
 MATES WITH MODULAR PLUG CONFORMING TO FCC PART 68,SUBPART F.

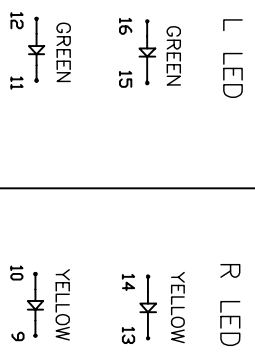
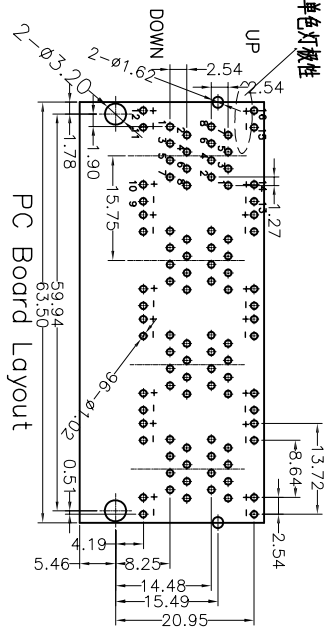
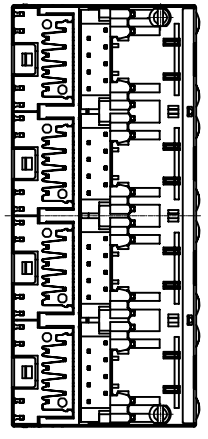

PART NUMBER: 59A-S2488L2-E2XX

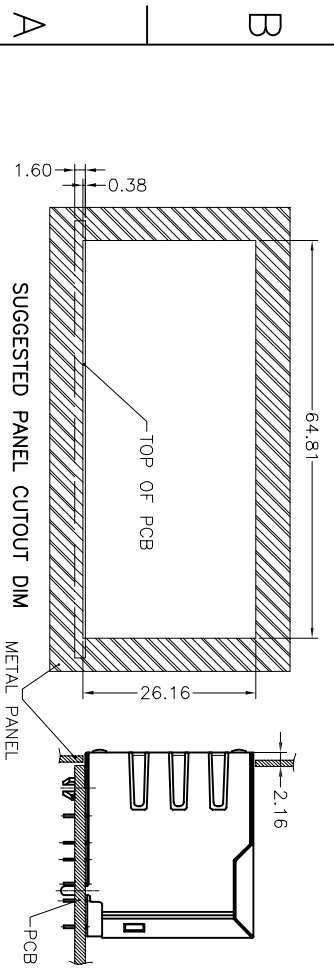
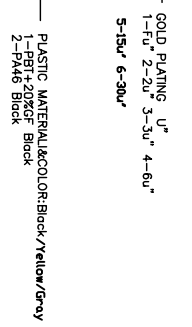

| | | | |
|--------------------------------------|-----------|---|---|
| HTTP://WWW.RJ45JACK.COM | | YOU LONG CONNECT THE WORLD | |
| YOU LONG ELECTRONICS LIMITED | | YOU LONG ELECTRONICS LIMITED | |
| DIMENSION IN mm [Inch] | | TITLE | |
| TOLERANCE UNLESS OTHERWISE SPECIFIED | | 59A 2X4 8PBC PCB JACK WITH LED & SHIELDED SIDE ENTRY FLAT PIN | |
| .X±0.20 | X"± 1" | 图号 | DWG NO.YL59A-S2488L2-E0 |
| .XX±0.15 | .X"± 0.5" | 文件 | FILE NO. |
| .XXX±0.075 | | 版本 | 59A 2X4 8PBC PCB JACK WITH LED & SHIELDED SIDE ENTRY FLAT PIN |
| 批准 | 批准 | 日期 | DATE |
| APPROVE | CHECK | DRAW | Oscar |
| 比例 | 比例 | 图幅 | 图幅 |
| SCALE | SCALE | SIZE | SIZE |
| 1:1 | 1:1 | A3 | A3 |
| 1 | 1 | REV | REV |
| A | A | | |