

# 1 Port RJ-45 Jack Top Entry With 100/1000 Base-T Magnetics Module

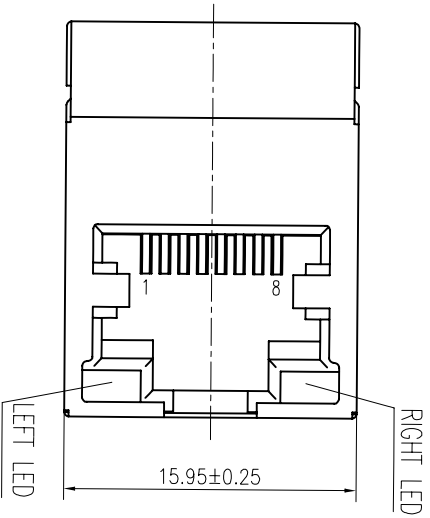
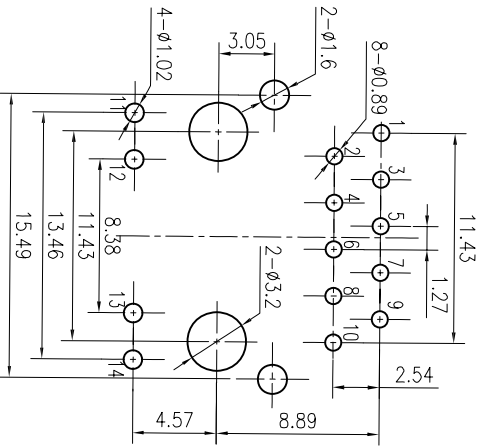
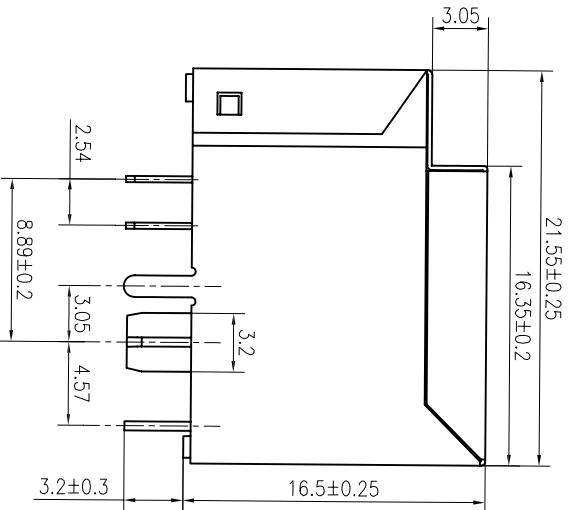
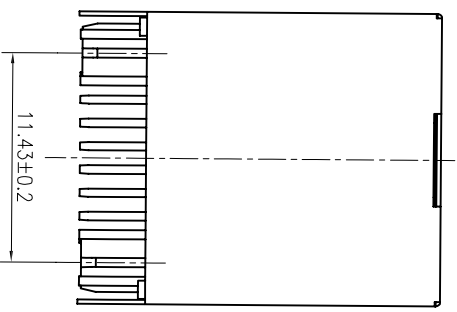

## DESCRIPTION

RJ45 With Internal Magnetics Connector  
Designed to support such applications as: Ethernet Equipment Complex, Switches, Routers, Firewalls, Servers and Hub  
Internal magnetics are 100% electrically tested for functionality per IEEE802.3 requirement

**ELECTRICAL:**  
RoHS peak wave solder temperature rating 235°C  
High performance for maximum EMI suppression  
350uH minimum OCL with 8mA bias current  
PoE rating: 15W, 350mA, 48V (For PoE Products only)

**MECHANICAL:**  
JACK CAVITY CONFORMS TO FCC RULES AND REGULATIONS, PART 68 SUBPART F.  
INSERTION FORCE: 2 CONTACTS-----350g 4 CONTACTS-----500g  
6 CONTACTS-----750g 8 CONTACTS-----900g  
10 CONTACTS-----1050g  
RETENTION STRENGTH: 7.7Kgs BETWEEN JACK AND PLUG  
DURABILITY: 750 MATING CYCLES Mini

**MATERIAL:**  
HOUSING: 1) GLASS FILLED PA66 (UL 94V-0)  
2) GLASS FILLED PA46/LCP (UL 94V-0)  
3) GLASS FILLED PBT (UL 94V-0)

SPRING WIRE: 1) 0.2-0.45mm DIA PHOSPHOR BRONZE GOLD PLATING OVER NICKEL  
2) 0.2-0.35mm THICKNESS PHOSPHOR BRONZE ALLOY SELECTIVE GOLD PLATING OVER NICKEL  
SHIELDING: 0.12-0.24mm THICKNESS COPPER ALLOY WITH TIN PLATED  
GOLD PLATING: 3µ", 6µ", 15µ", 30µ", 50µ"  
WORKING TEMPERATURE: -40°C to +85°C  
TOLERANCES UNLESS OTHERWISE SPECIFIED: 0~10H/0.15, 10~20±0.2, 20~40±0.25, 40~70H/0.3, >70H/0.4

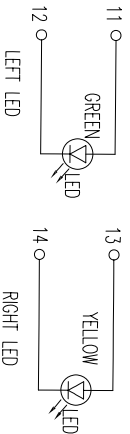

REV	变更内容 MODIFICATION	日期 DATE	制图 DRAW	审核 APPROVE
A	版面发行	2012/10/29	JDL	Oscar

HTTP://WWW.RJ45JACK.COM		YOU LONG CONNECT THE WORLD	
DIMENSION IN mm [Inch]		YOU LONG ELECTRONICS LIMITED	
TOLERANCE UNLESS OTHERWISE SPECIFIED		图号 DRAW NO. HRJ-YLS2D1000VNL	
.X±0.20	X*±1"	文件号 FILE NO.	
.XXX±0.15	.X*±0.5"	标题 TITLE	
.XXX±0.075		100/1000Base-T Magnetics Module RJ45 PCB JACK WITH SHIELDED, TOP ENTRY, TAB-UP, Flat PIN	
QC	检验 CHECK	Oscar	审核 REV
CPK	制程 APPROVE	1:1	A3

If you have any questions, Don't hesitate to email sales@rj45jack.com, please!

**ELECTRICAL SPECIFICATIONS @ 25°C/+5°C unless otherwise noted:**

Schematics:

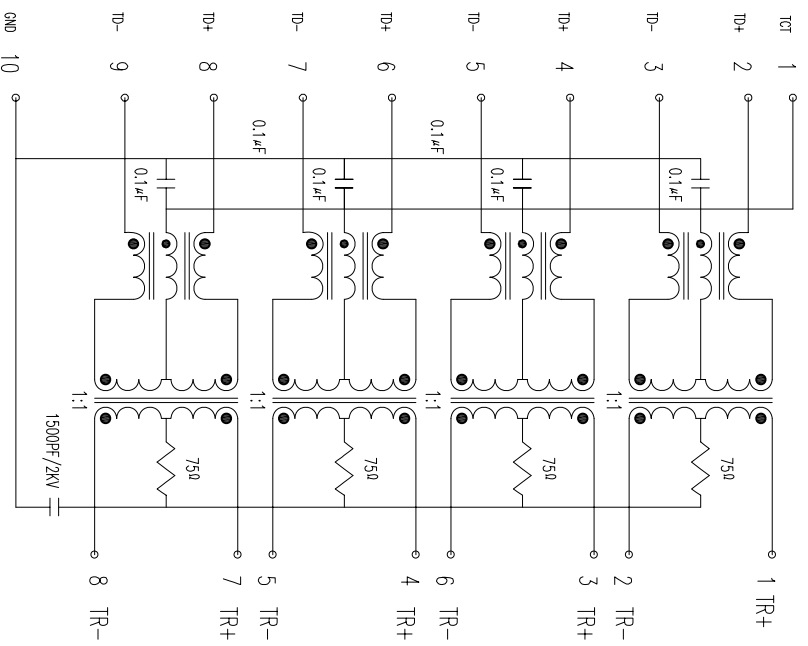

PART NUMBER: HRJ-YL52D1000VNL-XX

5-15µ" 6-30µ"  
 GOLD PLATING U"  
 1-Fu" 2-2u" 3-3u" 4-6u"  
 PLASTIC MATERIAL&COLOR:Black/Yellow/Gray  
 1-PA46 Black  
 2-PA46 Black

REV	更改内容 MODIFICATION	日期 DATE	制图 DRAW	审核 APPROVE
A	版面发行	2012/10/29	JDL	Oscar

**Insertion Loss: 1-100MHZ -1.0dB MAX**

**Return Loss: 1-30MHZ -18.0dB MIN  
 30-60MHZ -16.0dB MIN  
 60-100MHZ -12.0dB MIN**

**Cross Talk: 1-30MHZ -40.0dB MIN  
 30-60MHZ -35.0dB MIN  
 60-100MHZ -30.0dB MIN**

**CMR: 1-50MHZ -30.0dB MIN  
 50-150MHZ -20.0dB MIN**

**Hi-Pot: 1500V AC 6S 0.5mA**

**OCL:350uH MIN @ 100KHZ 100mV 8mA DC**

**Turn Ratio: 1CT:1CT+/-3%**

HTTP://WWW.RJ45JACK.COM

YOU LONG CONNECT THE WORLD

YOU LONG ELECTRONICS LIMITED

100/1000Base-T Magnetics Module RJ45 PCB JACK  
 WITH SHIELDED , TDP ENTRY,TAB-UP,Flat PIN

FILE NO. HRJ-YL52D1000VNL

DWG NO. OSCAR

SCALE 1:1

SIZE A3

REV 1